

NOTES
 Use only figured dimensions
 Do not scale except in connection with Planning Applications
 Contractor to check all dimensions and notify CA of any discrepancies
 Copyright of this drawing remains with W.GRIFFITHS

Rev.	Desc.	Date
E	PAC Submission	20-05-20
D	3m buffer added to boundary, crpark layout amended to suit	0-05-20
C	Block B moved, parking amended	29-04-20
B	General Revisions FOR DISCUSSION	27-04-20
A	Pre app final	25-03-20

1m high loading bays to Block A

Total Car Parking - 41 Spaces

BLOCK A Areas :
 GF Units 1-4 : 242m²
 (FF Units 1-4 : Potential 60m²)
Totals :
 GF - 968m²
 (FF - 240m²)

BLOCK B Areas :
 GF Units 5-7 : 117m²
 (FF Units 5-7 : Potential 117m²)
Totals :
 GF - 351m²
 (FF - 351m²)

Carparking calculation assuming First Floor partially built:-
 $968m^2 + 351m^2 = 1319m^2 / 120 = 11$ parking spaces for workshops
 $240m^2 + 351m^2 = 591m^2 / 20 = 30$ parking spaces for offices

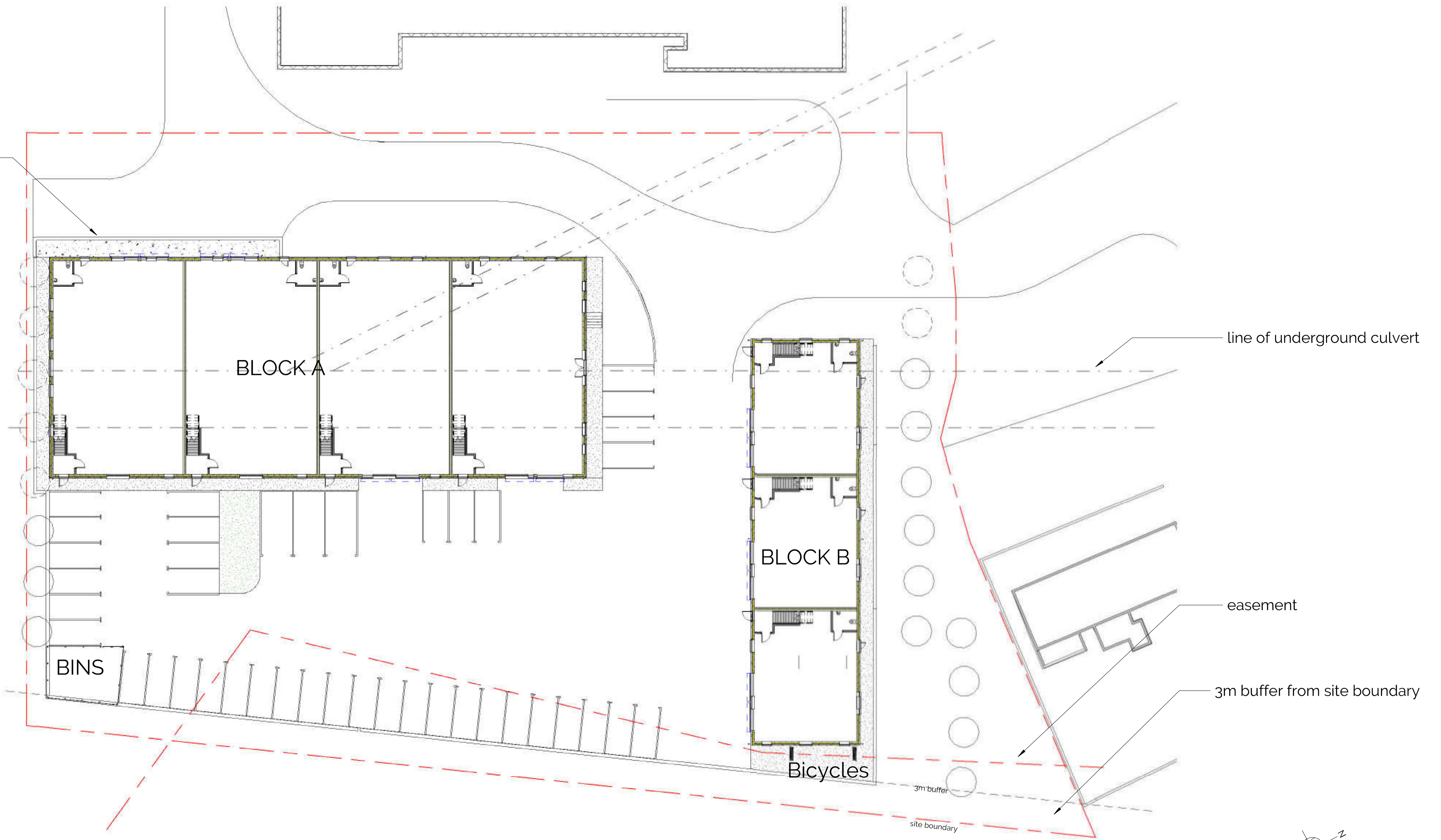

SITE LAYOUT

W.GRIFFITHS
 ARCHITECTS • PENSEIRI
 Falcon Chambers
 Thomas St Llanelli
 SA15 3JB
 www.wgriffiths.co.uk
 Tel. 01792 651532

PROJECT Redevelopment of Land Adjacent to Office Row, Ystalyfera

SCALE 1 : 200
 DRAWN -
 CHECKED -
 SIZE A1
 DATE 10/29/19
 DATE

TITLE SITE LAYOUT

1690	4-4	E
------	-----	---